

Before installing the urinal, make sure drain line is clean and clear of debris



Wall Bracket for ZF-101



Wall Bracket for ZF-201



Coupler



Drain Insert

Key

Odor Barrier

**Not Shown:**  
Screws, wall anchors, washers

### Replacing a Urinal

Shut off and cap water supply. Remove existing hardware, caulk and grout. Remove all traps and conventional siphons. Verify there is enough room for the new urinal.

# INSTALLATION INSTRUCTIONS FLOOR DRAIN MODELS

Do not install on any copper plumbing.



1

Measure from the floor no more than 24" up to the lip of the urinal, and mark the spot on the wall.



3

Hang the urinal. Ensure that the lip of the urinal will not be more than 24" from the floor. This measurement applies also to the troughs.

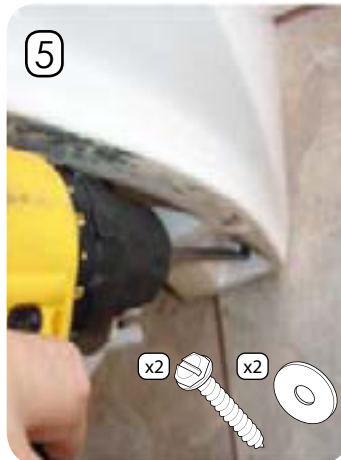

5

Using the 2 rubber washers and two 1.5in (38.1mm) screws, continue to anchor the bottom of urinal to the wall.

Perform a Water test for a good flow and verify there are no leaks.

Perform set-up following these set-up instructions.

Finish installation by caulking around the bowl.



2

Install the wall bracket. Make sure the bracket is level and centered.



4

After hanging the urinal connect it to the waste line using the coupler.

ZeroFlush™ Headquarters  
111 W. Olive Street  
Glendale, WI 53212

Phone: (407) 935-1180  
Toll Free: (877) 787-5383  
Fax: (407) 935-0001

Purleve™ | ZeroFlush™  
www.purleve.com  
www.zeroflush.com